

HELGOLAND RECESSED

design
Carlotta de Bevilacqua

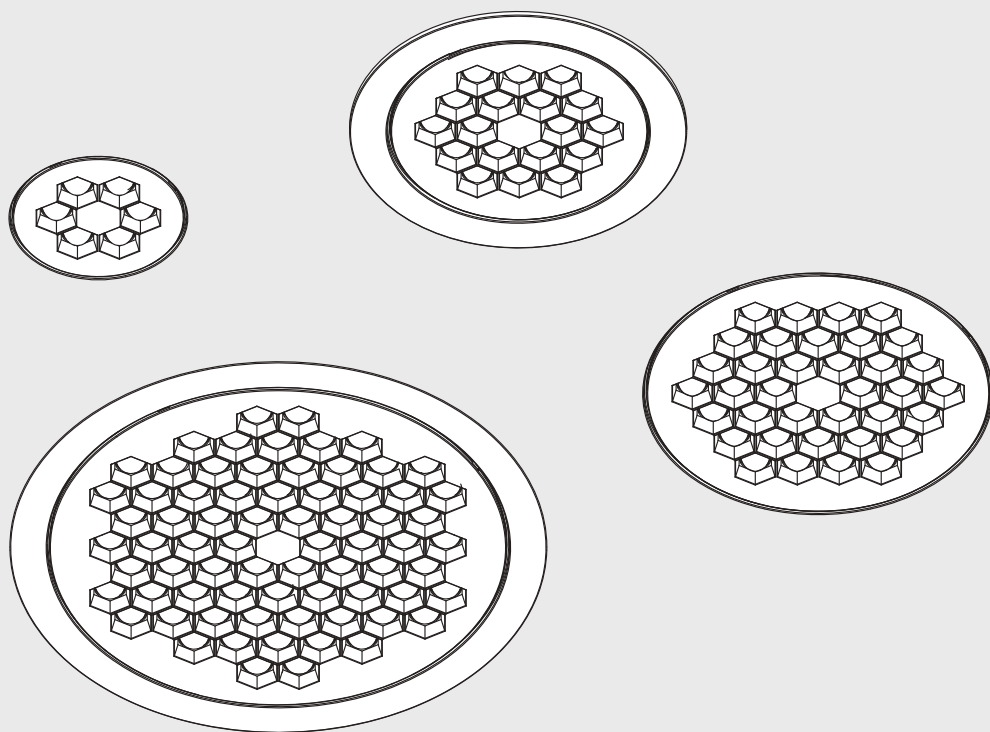



i

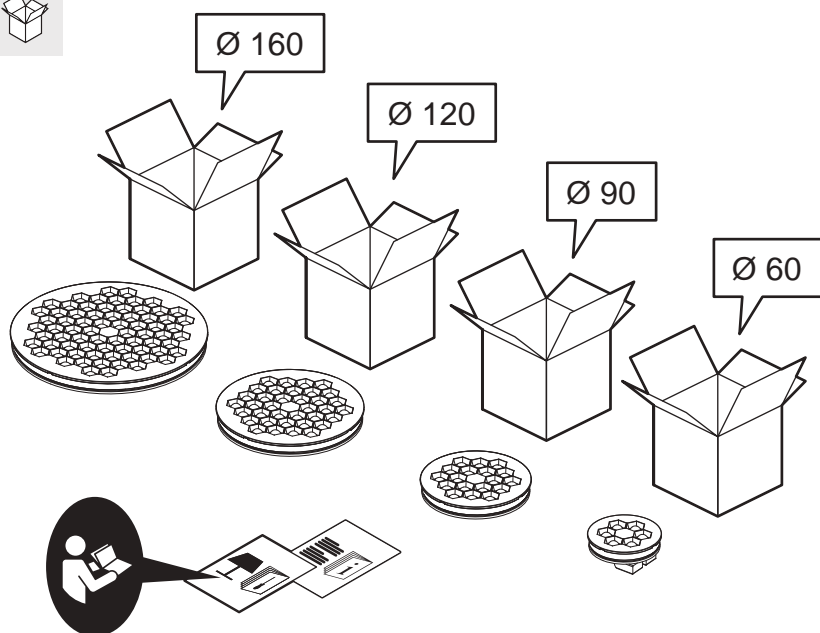
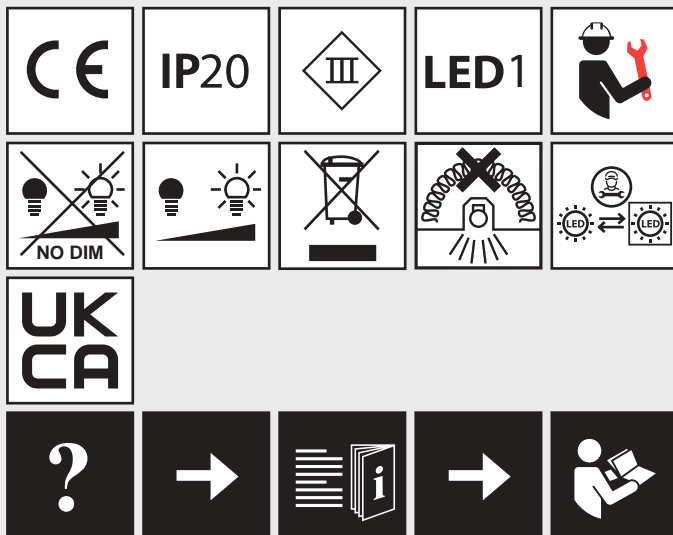



TRIM FRAME

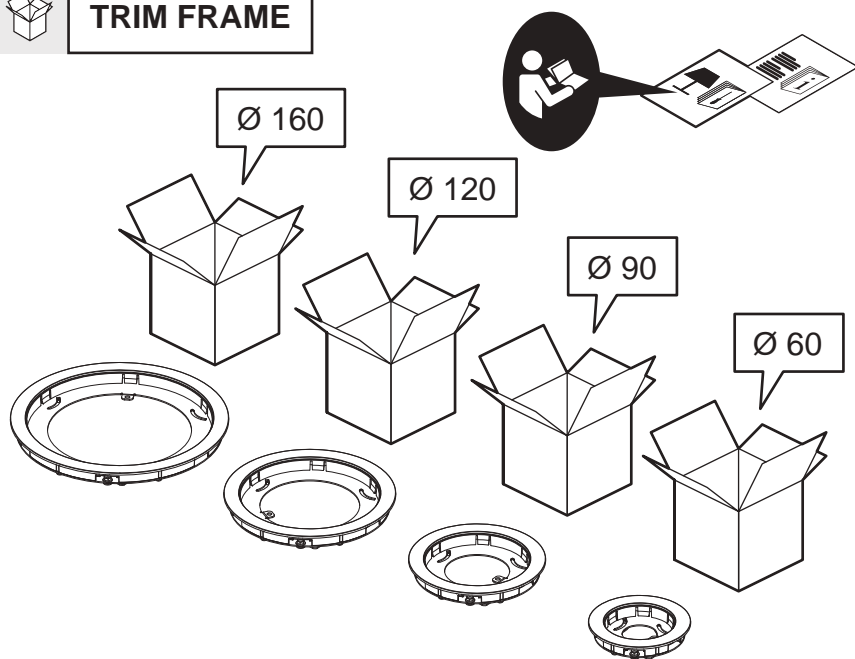

TRIMLESS FRAME

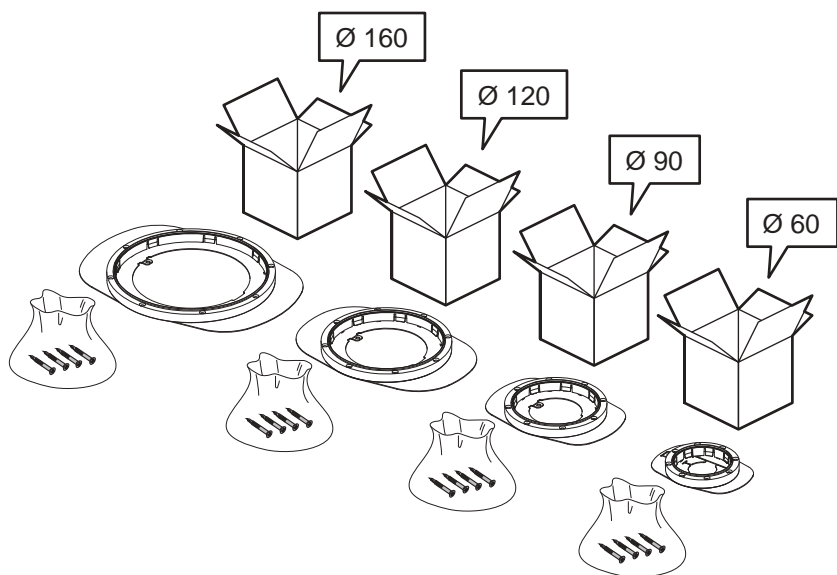



US / CANADA ONLY

AX90000

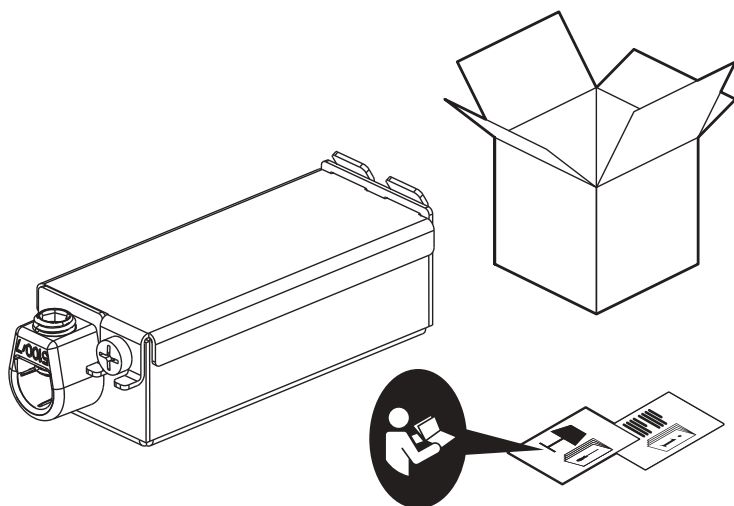

12.5 mm !

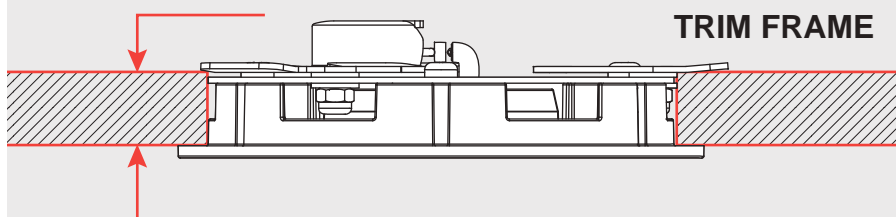

12.5 mm !

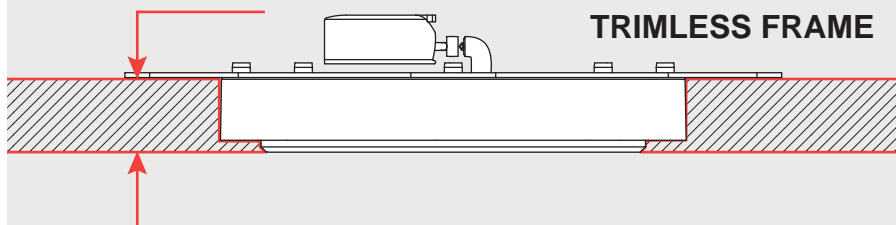

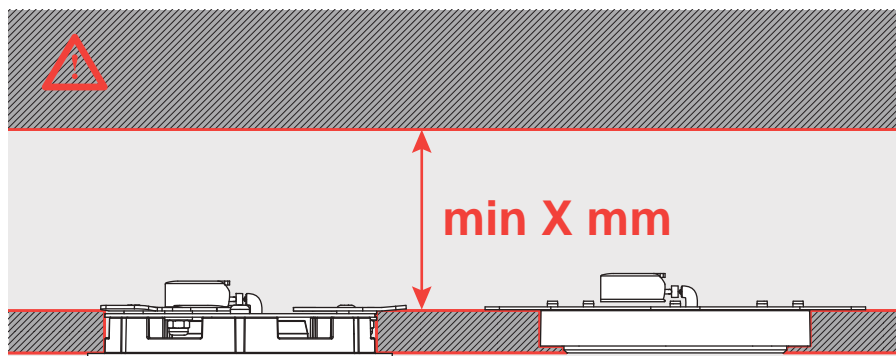

HELGOLAND Ø 60	X = 60 mm
HELGOLAND Ø 90	X = 90 mm
HELGOLAND Ø 120	X = 50 mm
HELGOLAND Ø 160	X = 30 mm

i

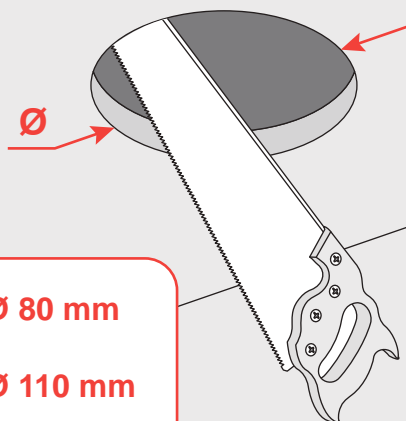

	Ø 60 → Ø 80 mm
	Ø 90 → Ø 110 mm
	Ø 120 → Ø 140 mm
	Ø 160 → Ø 180 mm

EU / WORLDWIDE

TRIM FRAME

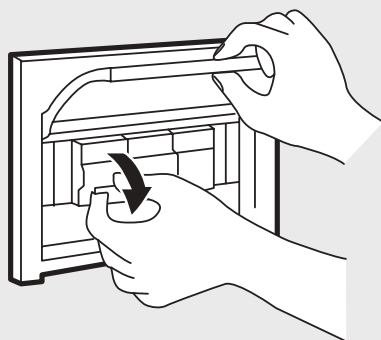

i

Ø 60

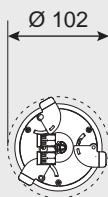

Ø 90

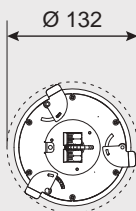

Ø 120

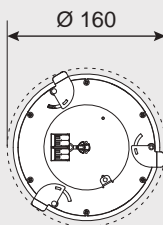

Ø 160

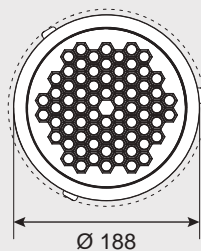
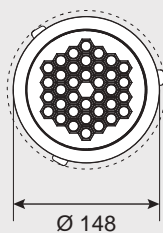
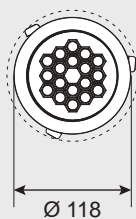
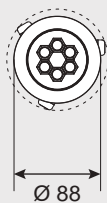
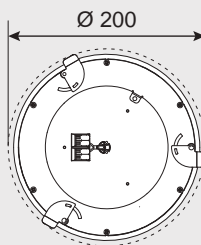

1a

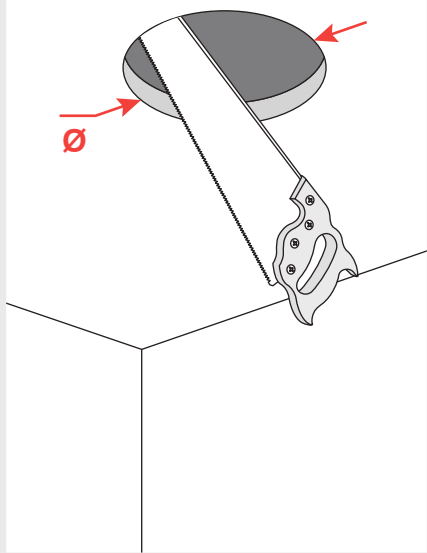

2a

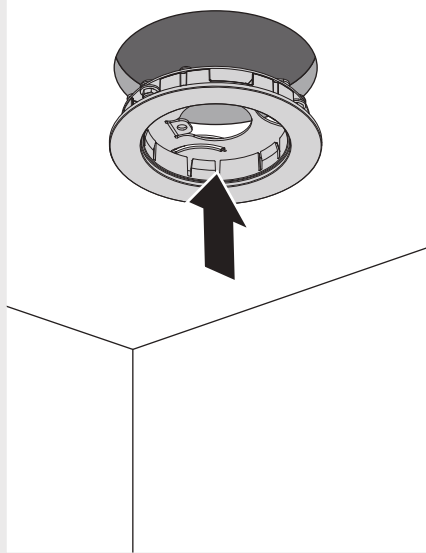

3a

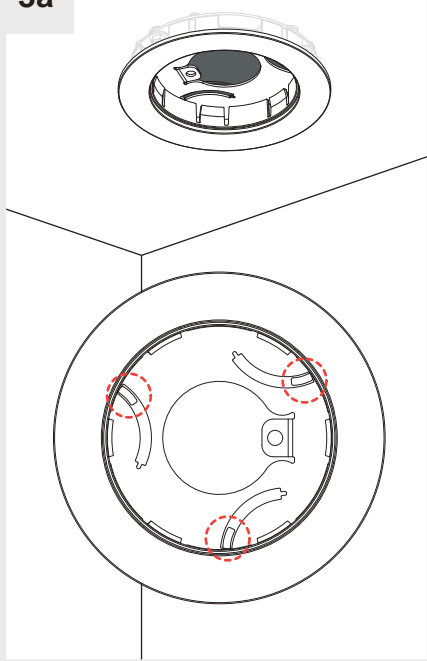

4a

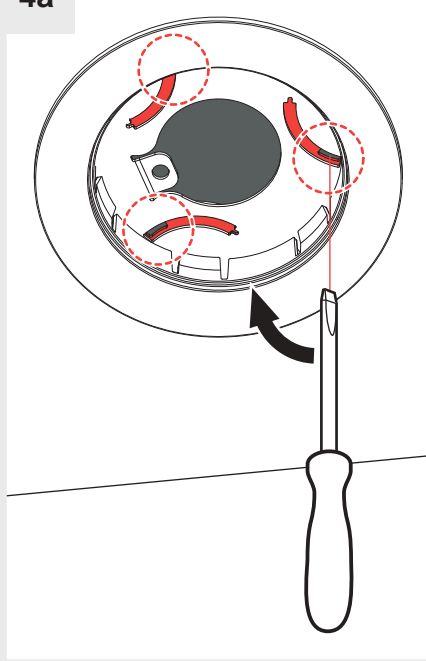

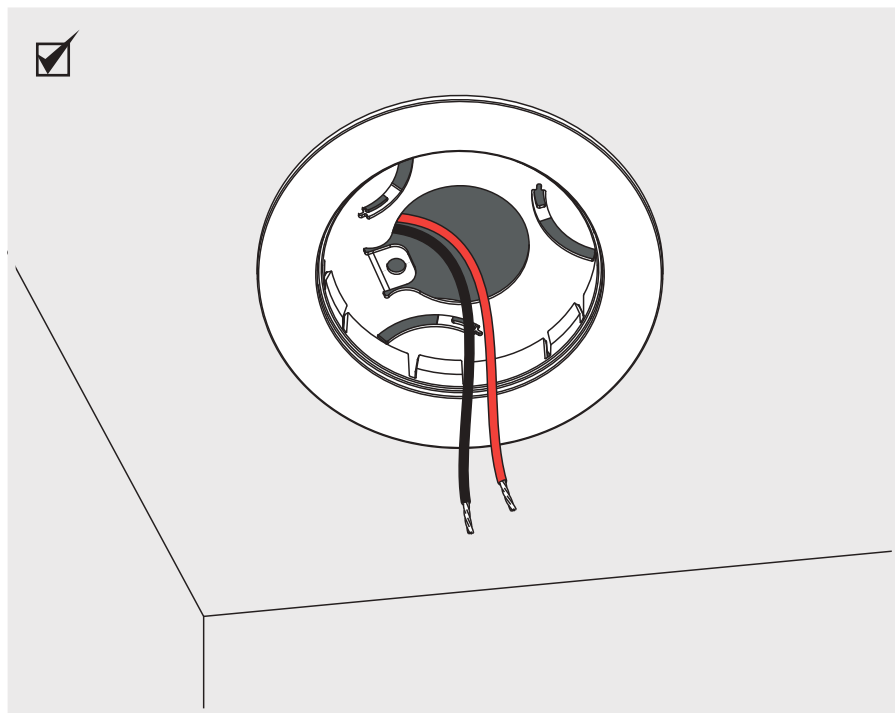
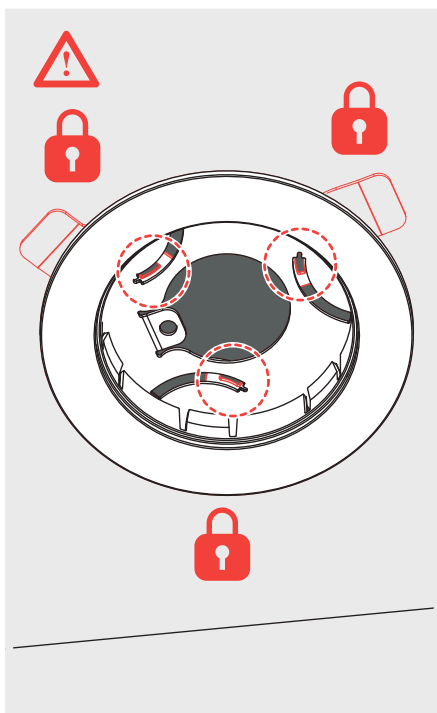
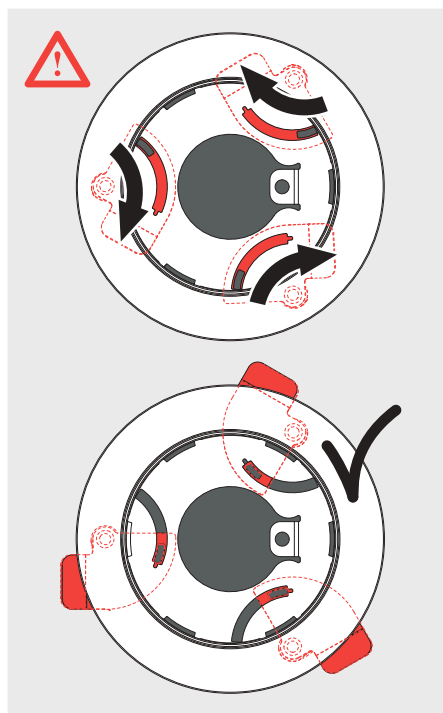

TRIMLESS FRAME

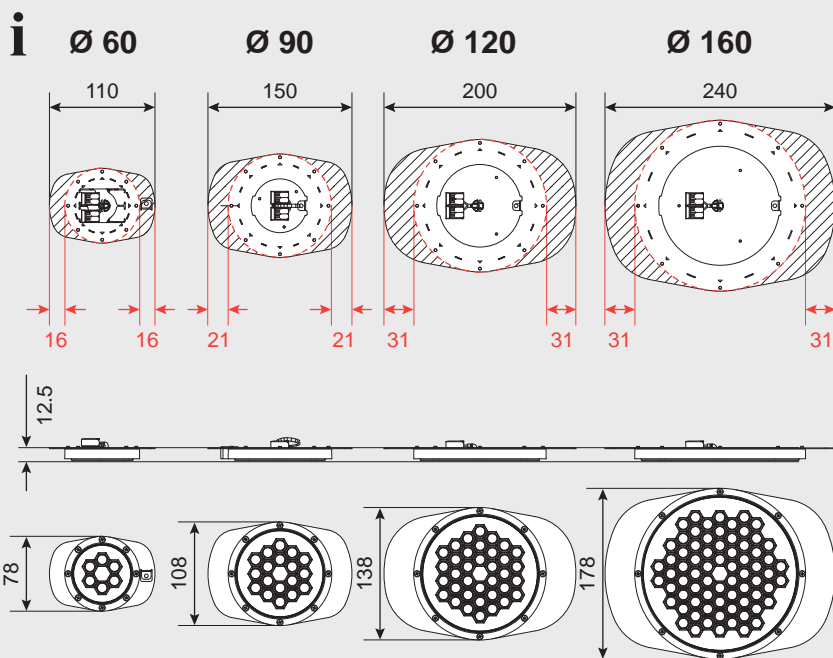
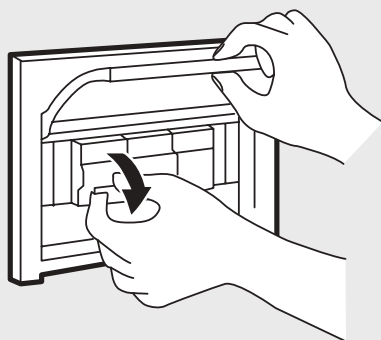

1b

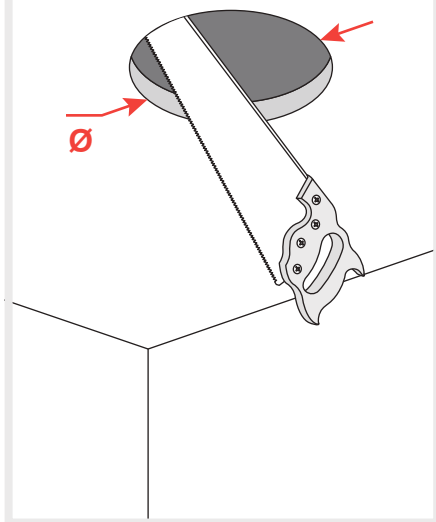

2b

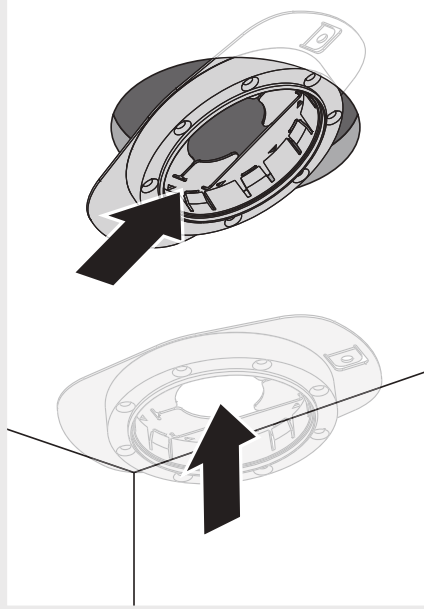

i

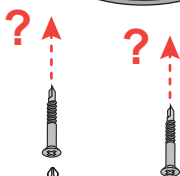
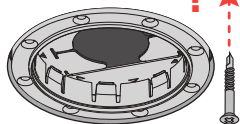

Ø 60

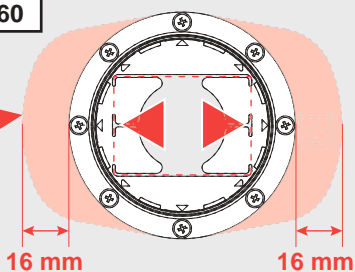

Ø 90-120-160

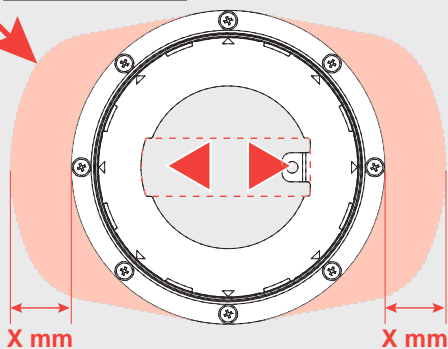

Ø	90	120	160
X [mm]	21	31	31

3b

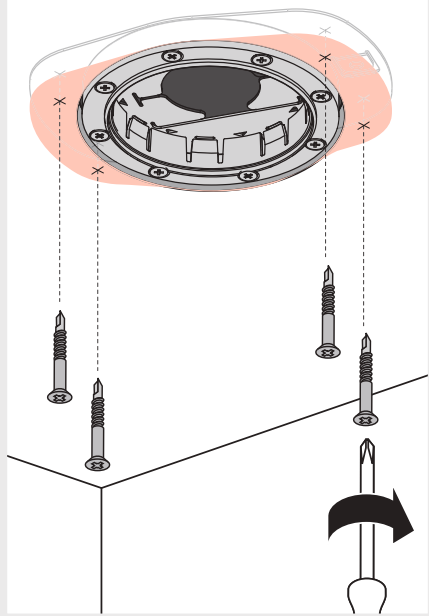

4b

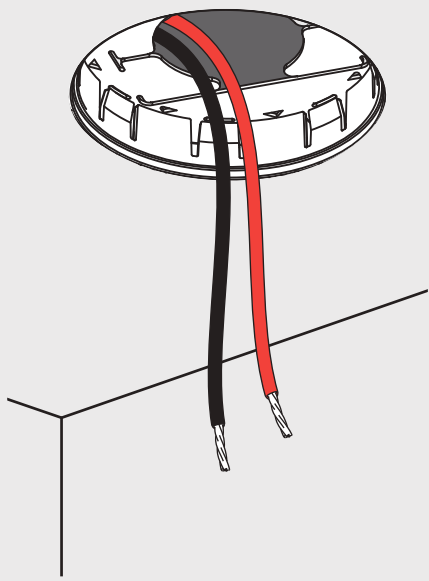
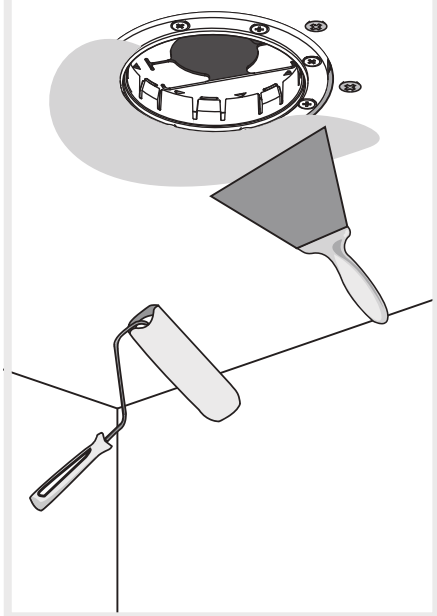

TRIM FRAME & TRIMLESS FRAME

5

OPTION 1

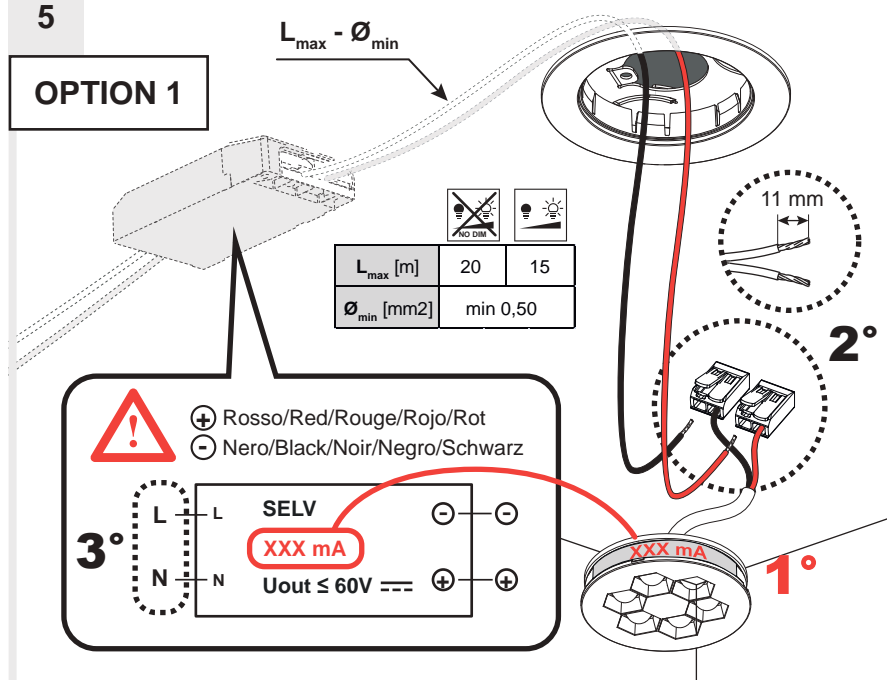

OPTION 2

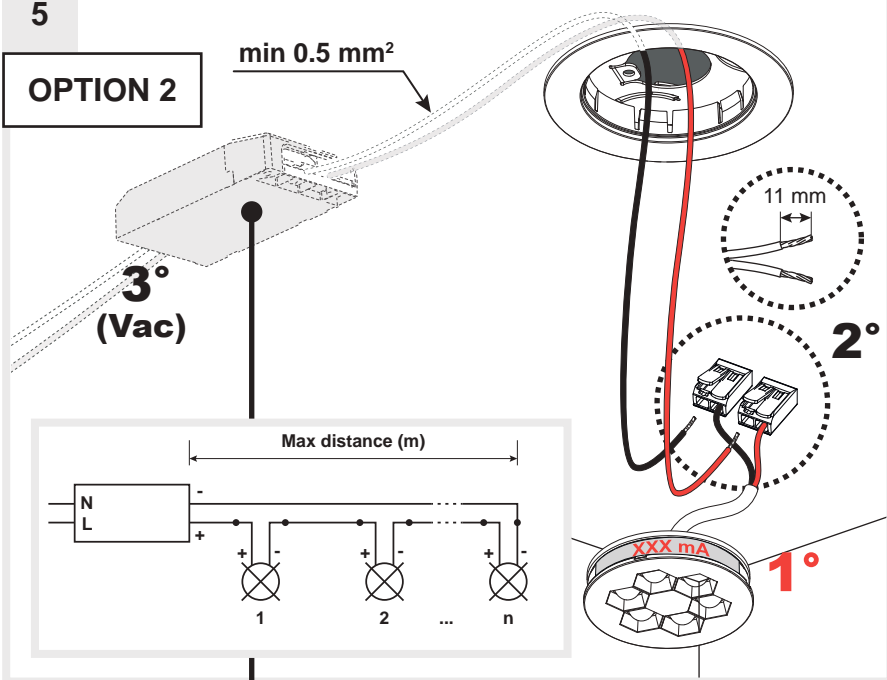

Helgoland sizes [Ø mm]	Remote driver type	Code	Driver dimensions			Circuit breaker	Max distance [m]	Current setting [mA]	V module	Devices nr.
			L [mm]	W [mm]	H [mm]					
60	ND	DV1037	146.5	42.5	22	A 16-30 B 16-50 C 16-70	20	300	8.5V	2 min 4 max
	DALI2 / 0-10 / PUSH	DV1126	111	52	22	A 16-30 B 16-50 C 16-70 D 16-100	15			1 min 5 max
	DALI2 / PUSH	DV1127	146.5	43.5	22		15			2 min 4 max
	APP & PUSH	DV1128APP	146.5	44	30		15			2 min 5 max
90	ND	DV1037	146.5	42.5	22	A 16-30 B 16-50 C 16-70	20	350	17V	1 min 2 max
	DALI2 / 0-10 / PUSH	DV1126	111	52	22	A 16-30 B 16-50 C 16-70 D 16-100	15			1 min 2 max
	APP & PUSH	DV1129APP	146.5	44	30		15			1 min 2 max

Helgoland sizes [Ø mm]	Remote driver type	Code	Driver dimensions			Circuit breaker	Max distance [m]	Current setting [mA]	V module	Devices nr.
			L [mm]	W [mm]	H [mm]					
120	ND	DV1037	146.5	42.5	22	A 16-30 B 16-50 C 16-70	20	500	17V	1 min 2 max
	DALI2 / 0-10 / PUSH	DV1126	111	52	22	A 16-30 B 16-50 C 16-70 D 16-100	15			1 min 2 max
	APP & PUSH	DV1104APP	124	79	22	A 16-20 B 16-30 C 16-50	15			1 min 2 max
160	ND	DV1037	146.5	42.5	22	A 16-30 B 16-50 C 16-70	20	500	34V	1 max
	DALI2 / 0-10 / PUSH	DV1126	111	52	22	A 16-30 B 16-50 C 16-70 D 16-100	15			1 max
	APP & PUSH	DV1104APP	124	79	22	A 16-20 B 16-30 C 16-50	15			1 max

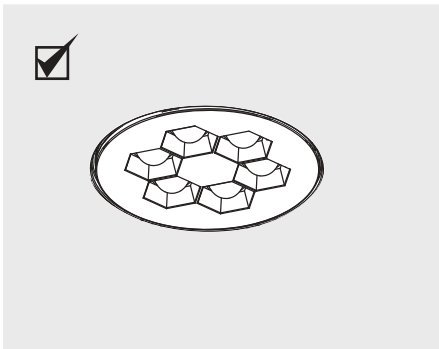
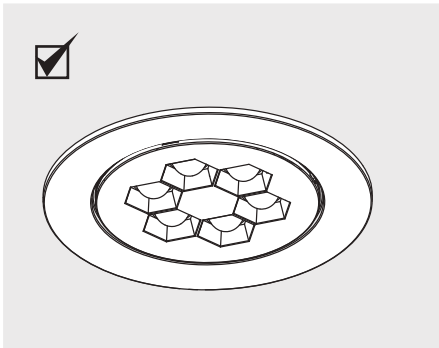
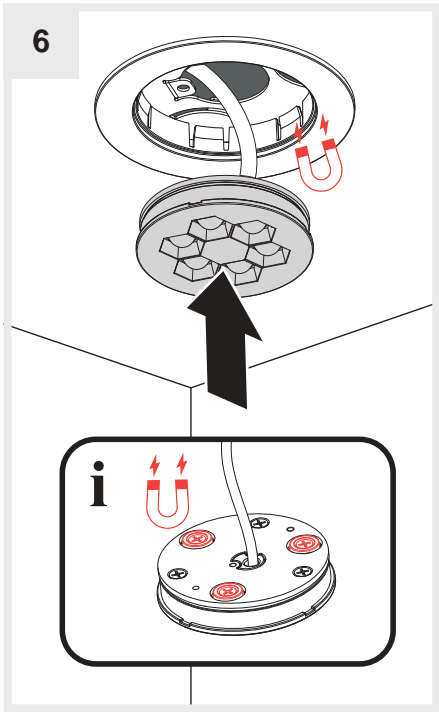

US / CANADA ONLY

Ø 60

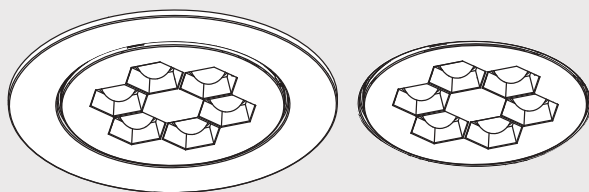

TRIM FRAME

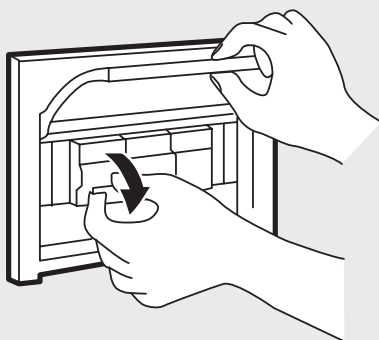

i

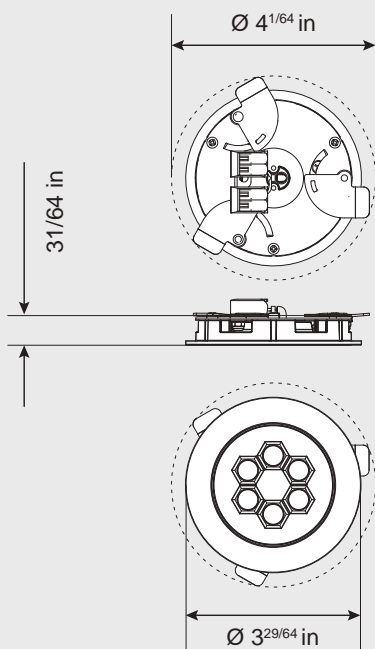

1a

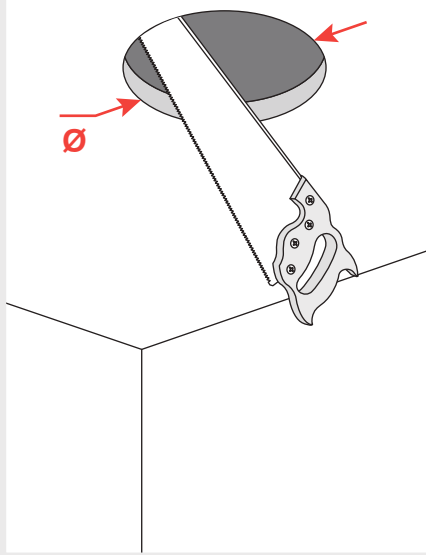

2a

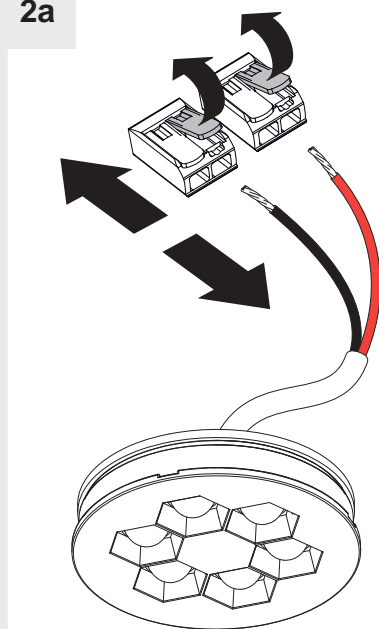

3a

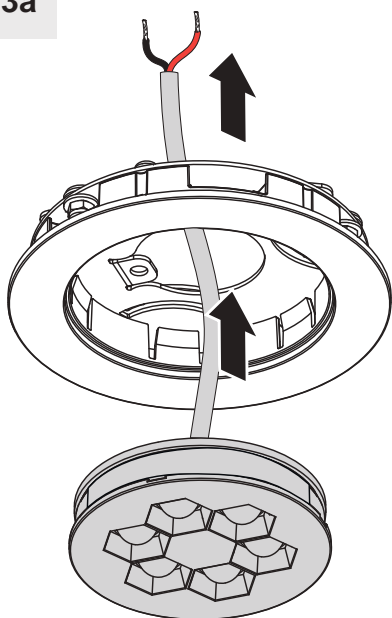

4a

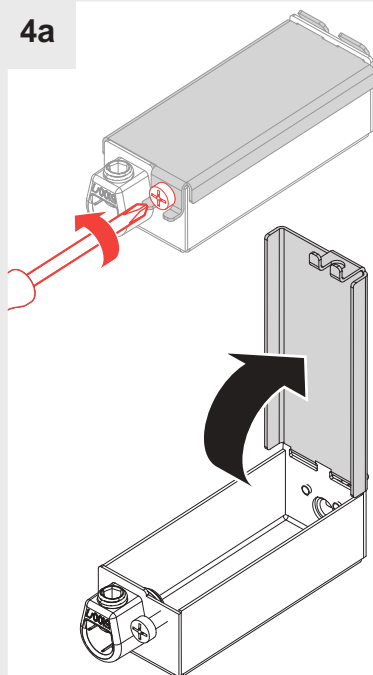

5a

Use only CMG cable
Utilisez uniquement CMG câble
Utilícese únicamente el cable CMG



Use only with class 2 power unit
Utiliser exclusivement avec class 2 alimentation
Utilícese únicamente con unidad de alimentación de clase 2

red/rouge/rojo + CLASS 2
black/noir/negro -



⊕ Rosso/Red/Rouge/Rojo/Rot
⊖ Nero/Black/Noir/Negro/Schwarz



CLASS 2

XXX mA

U_{out} ≤ 60V ===

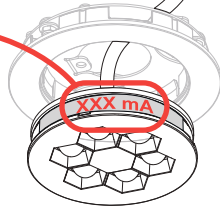
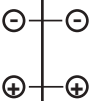

6a

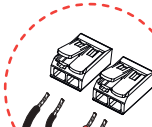

11 mm

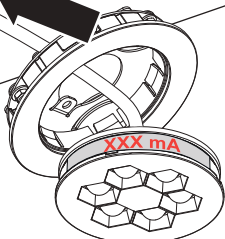
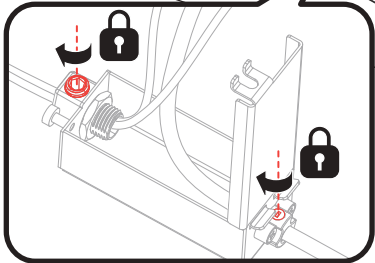
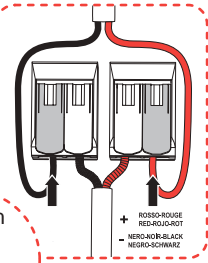

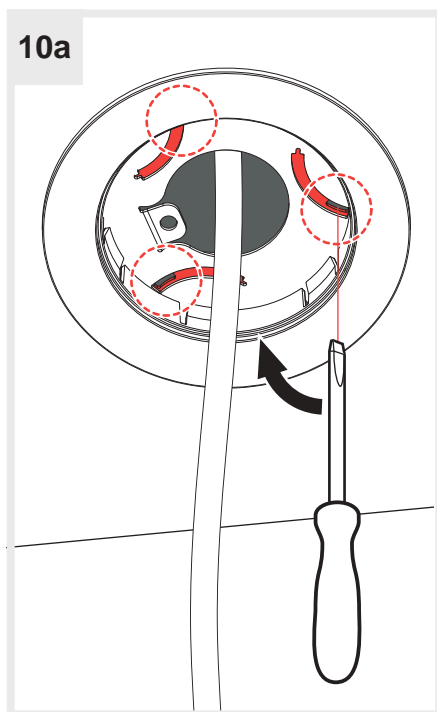
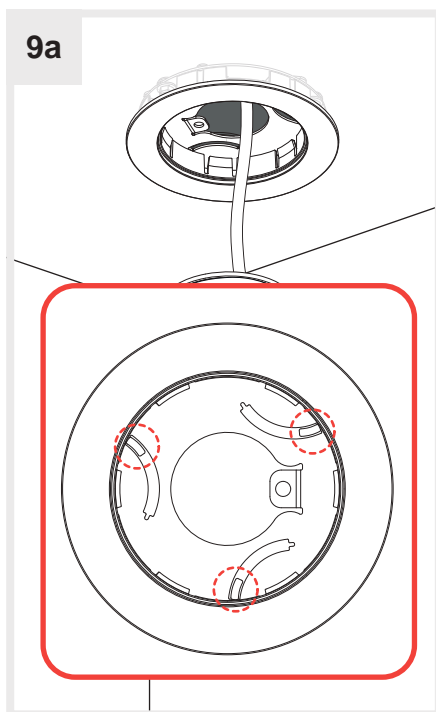
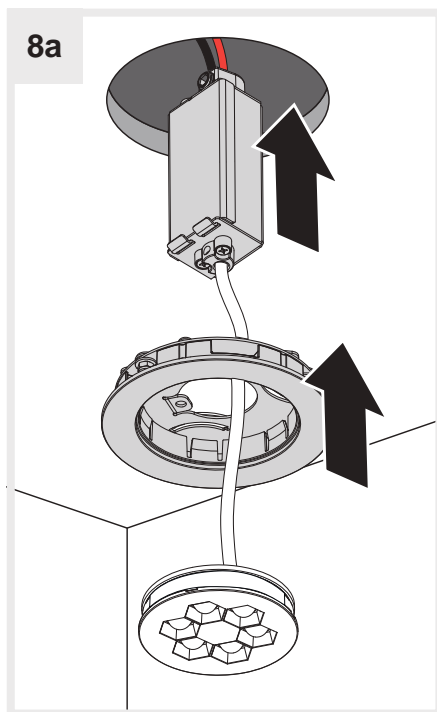
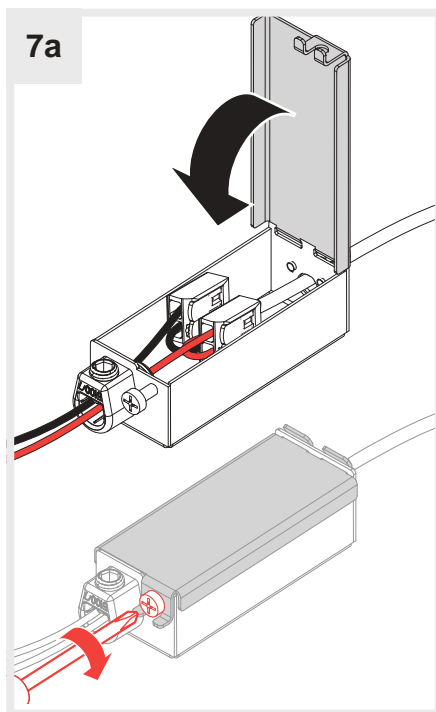

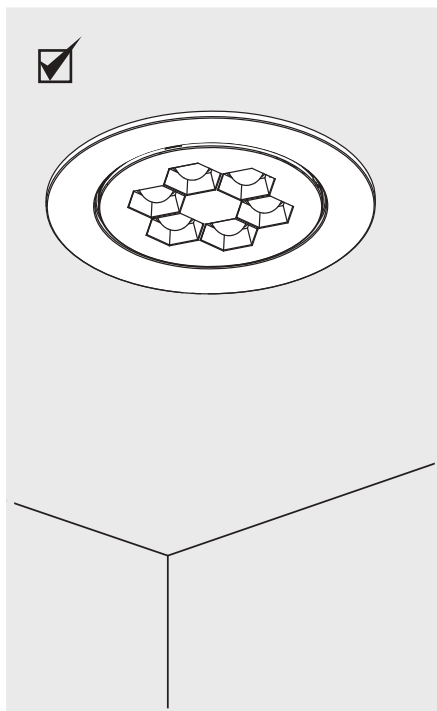
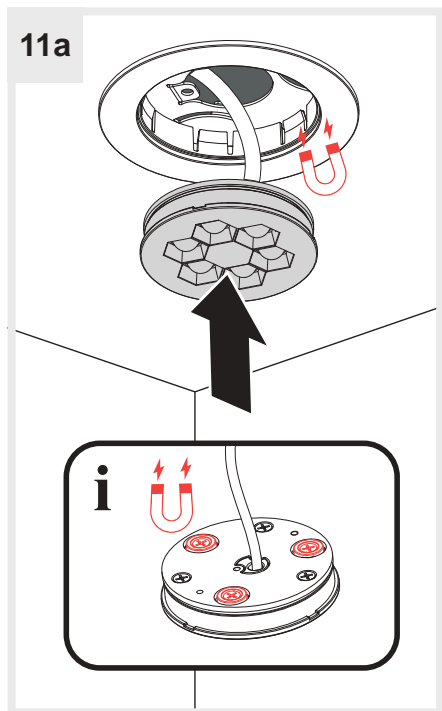
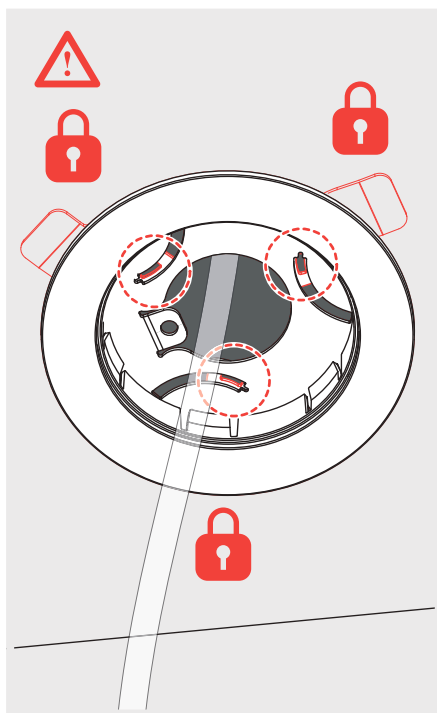
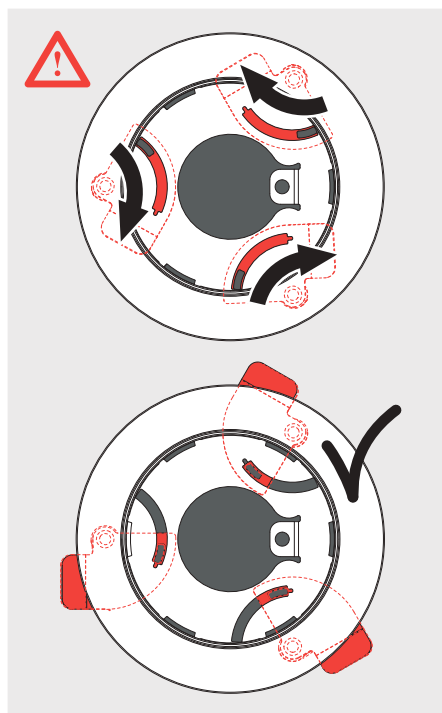

TRIMLESS FRAME

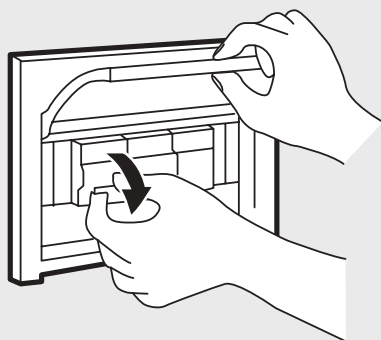

i

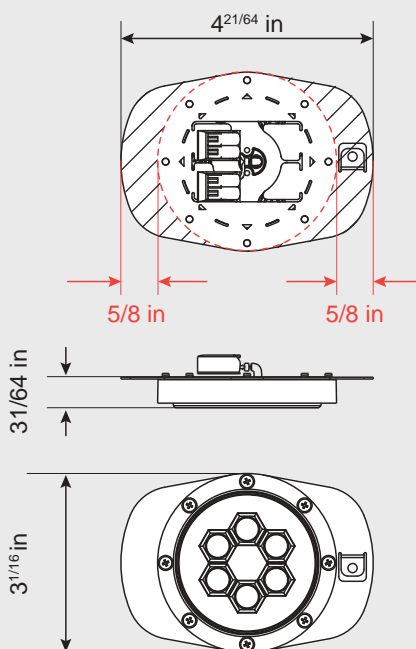

1b

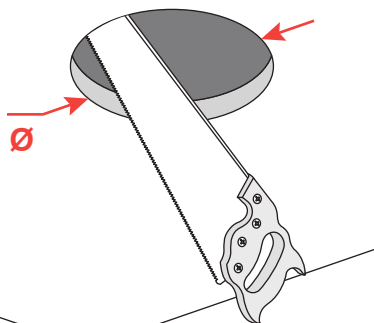

2b

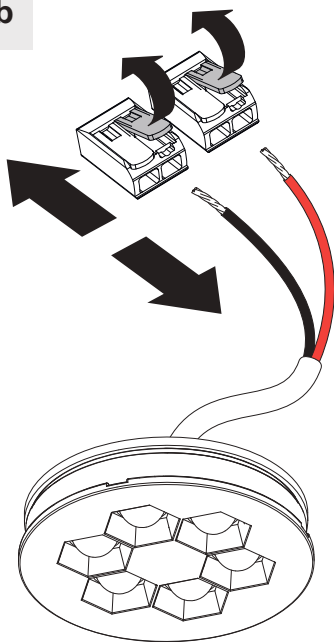

3b

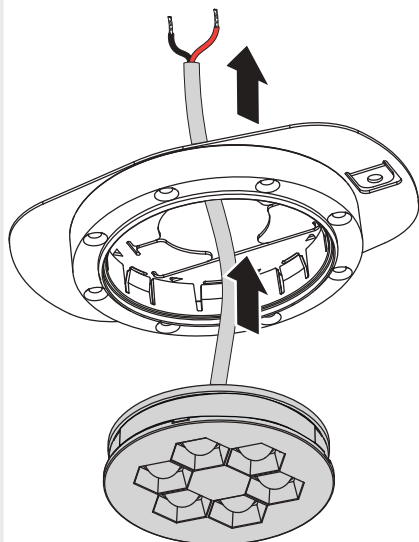

4b

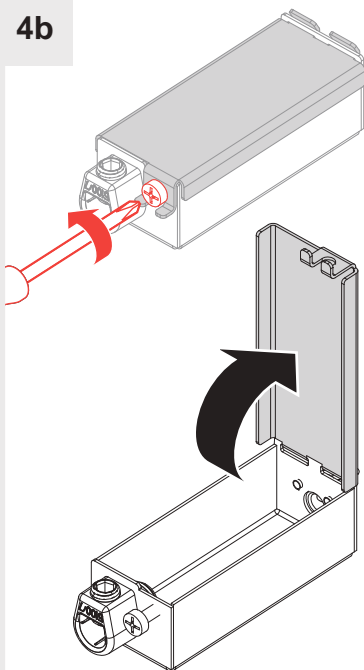

5b

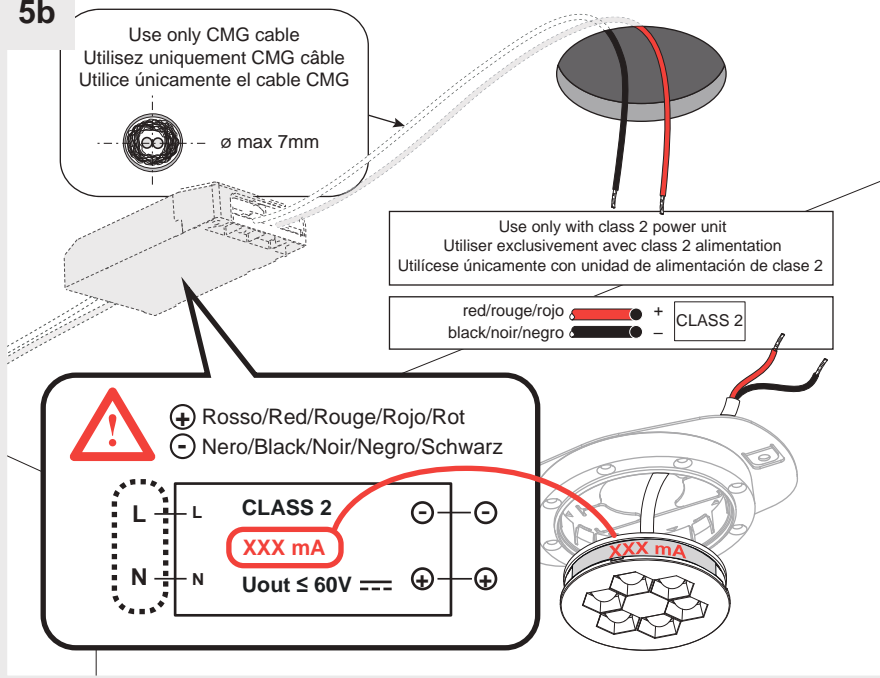

6b

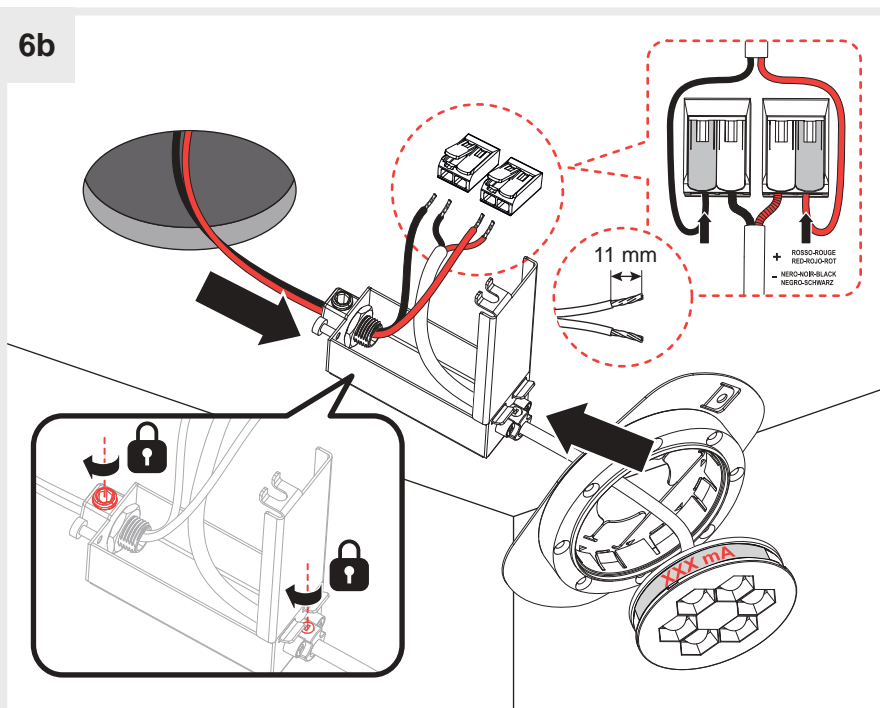

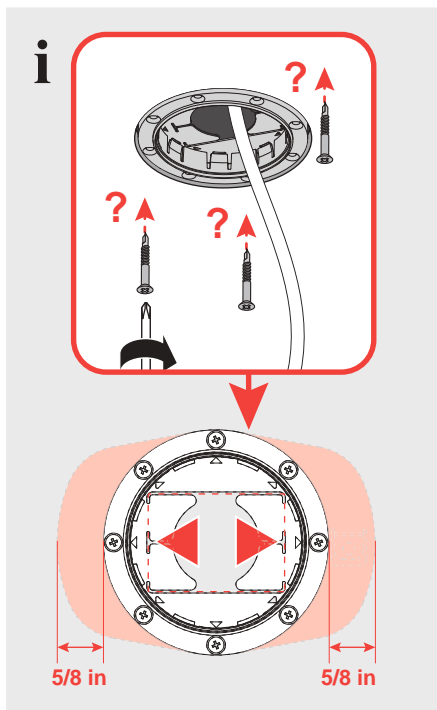
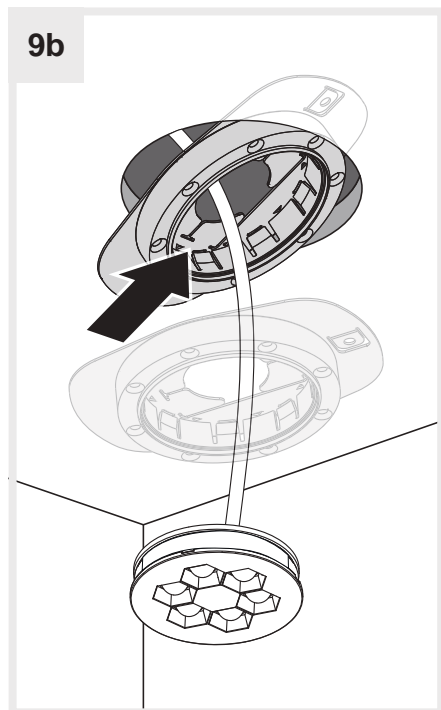
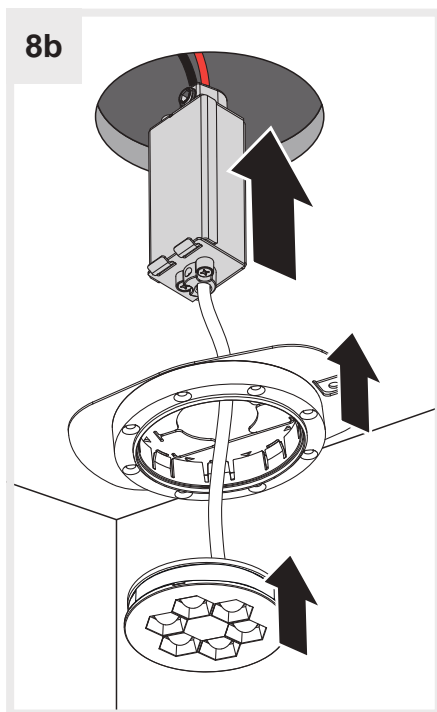
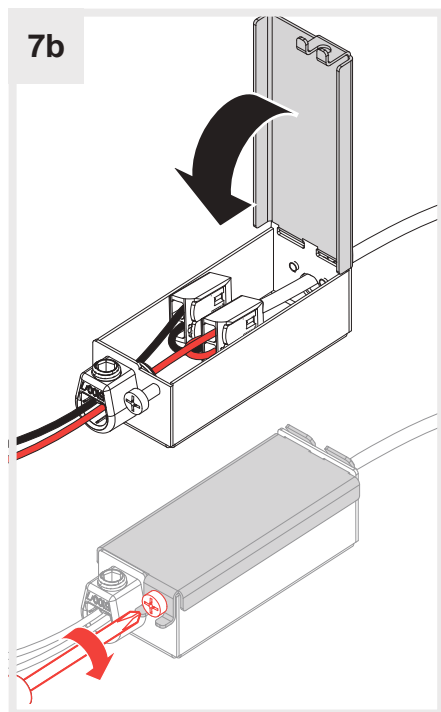

10b

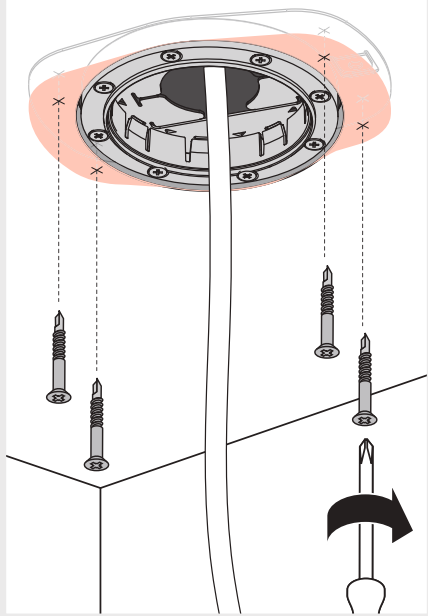

11b

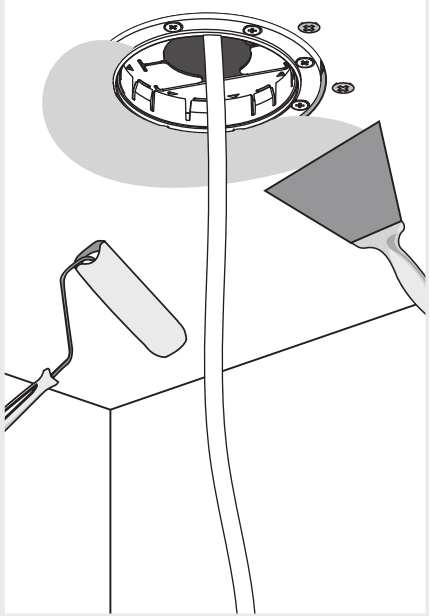

12b

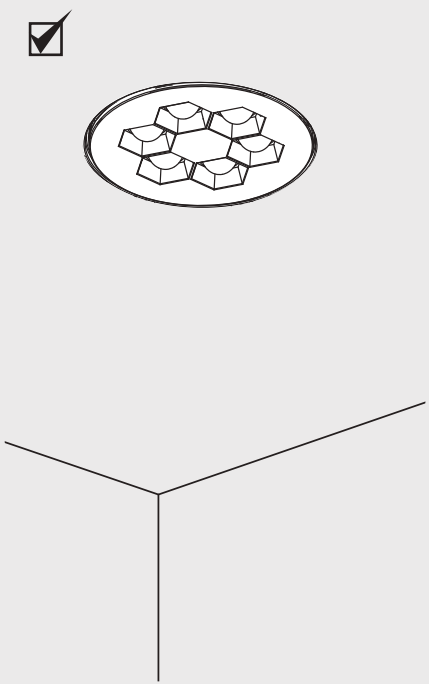
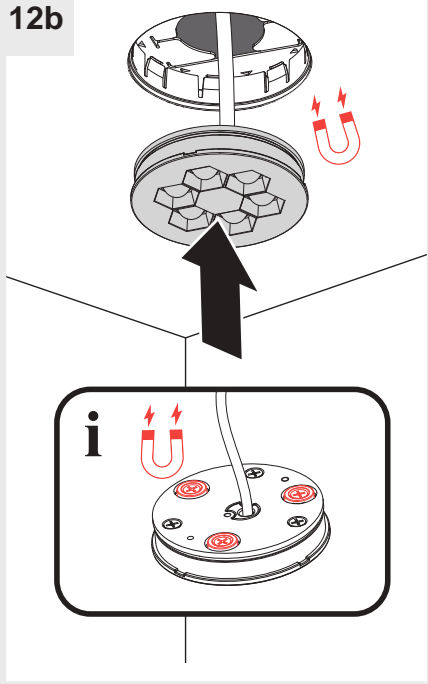

US / CANADA ONLY

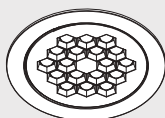

Ø 90

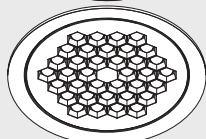

Ø 120

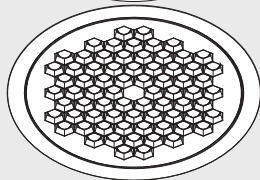
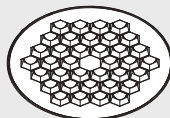

Ø 160

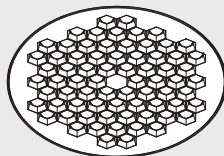

TRIM FRAME

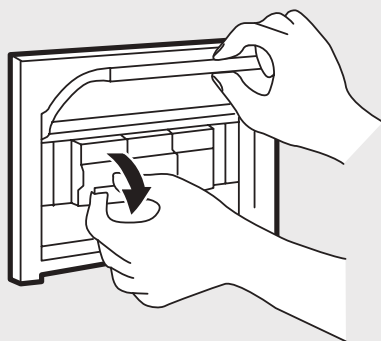

i

Ø 90

Ø 120

Ø 160

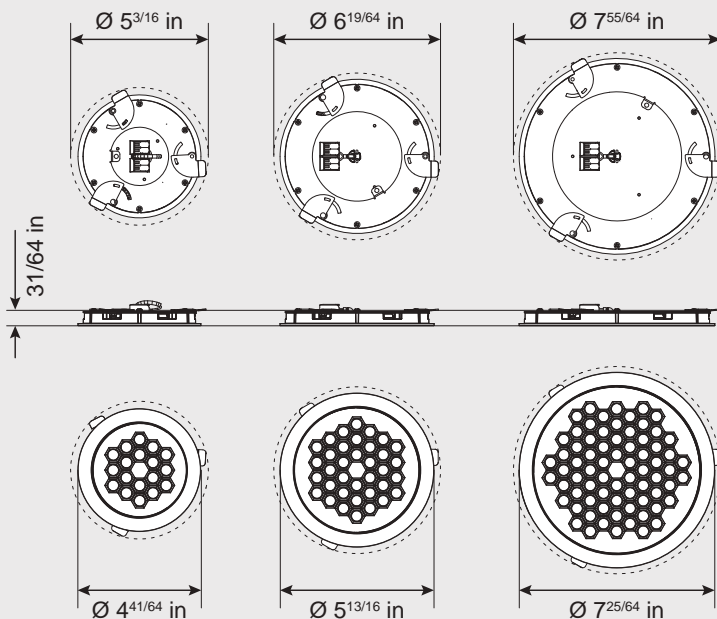

1a

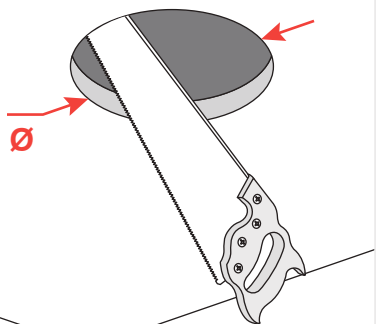

2a

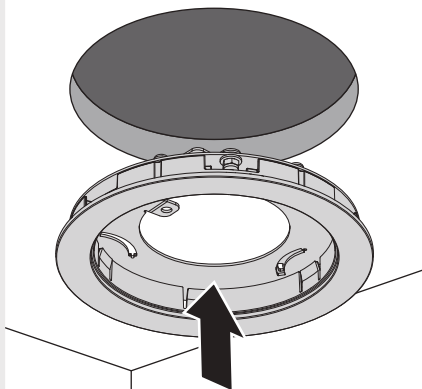

3a

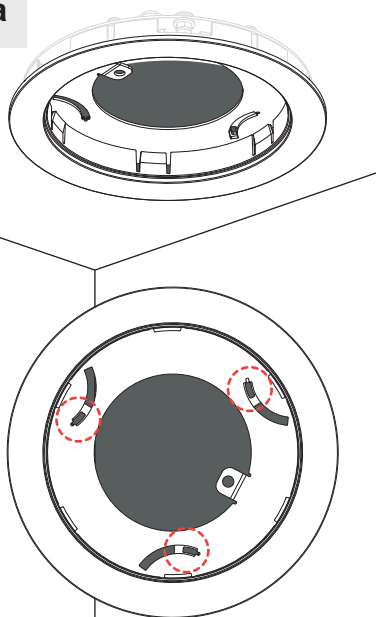

4a

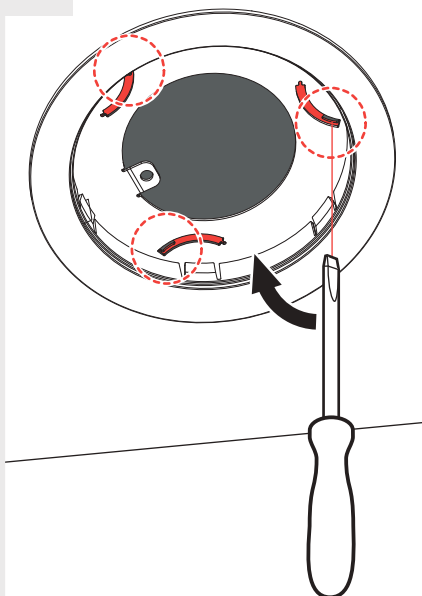

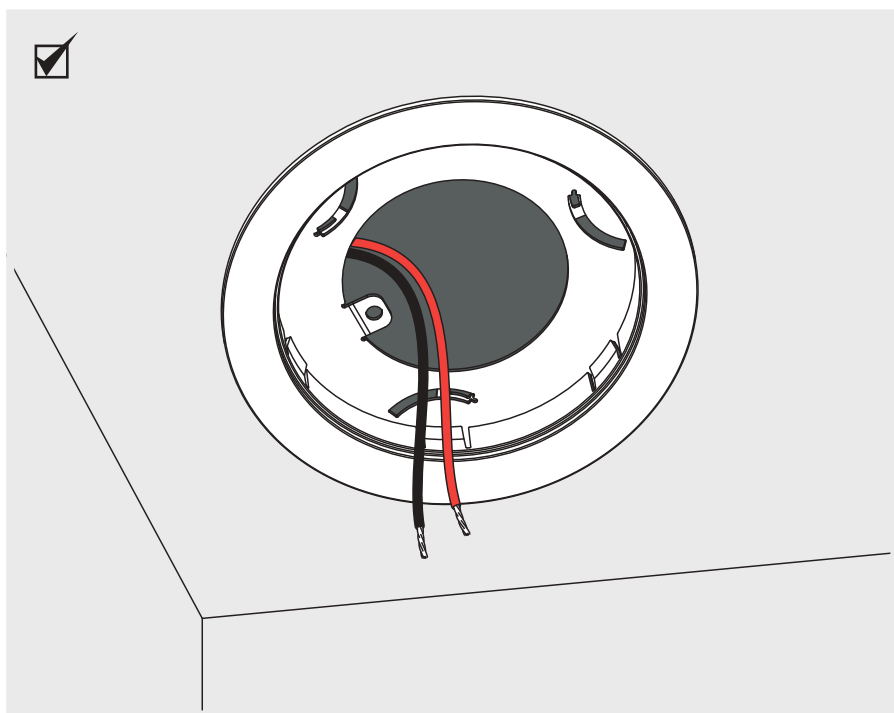
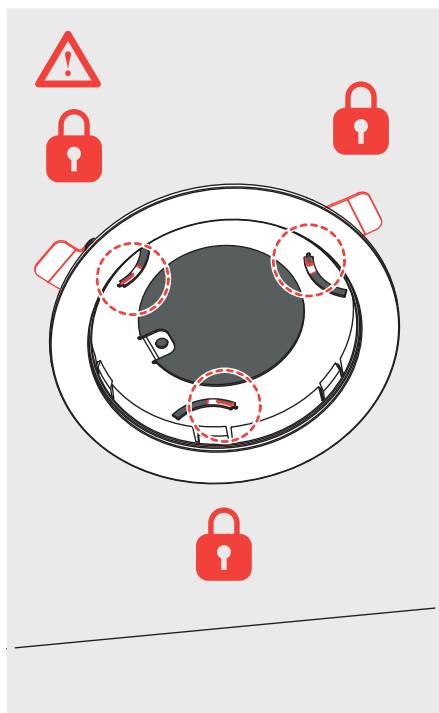
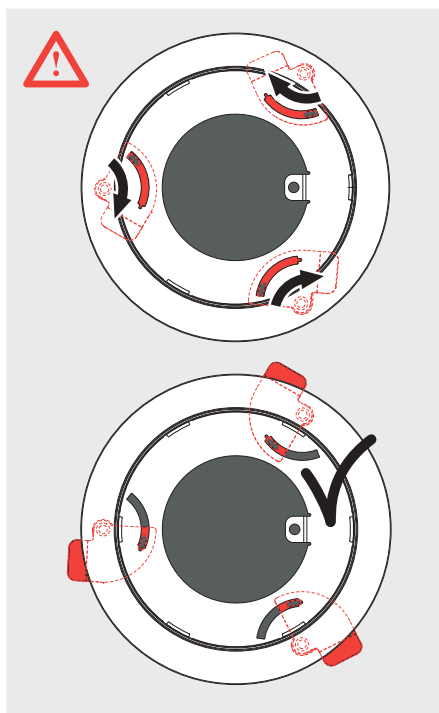

TRIMLESS FRAME

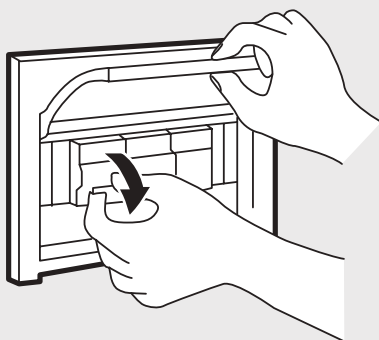

i

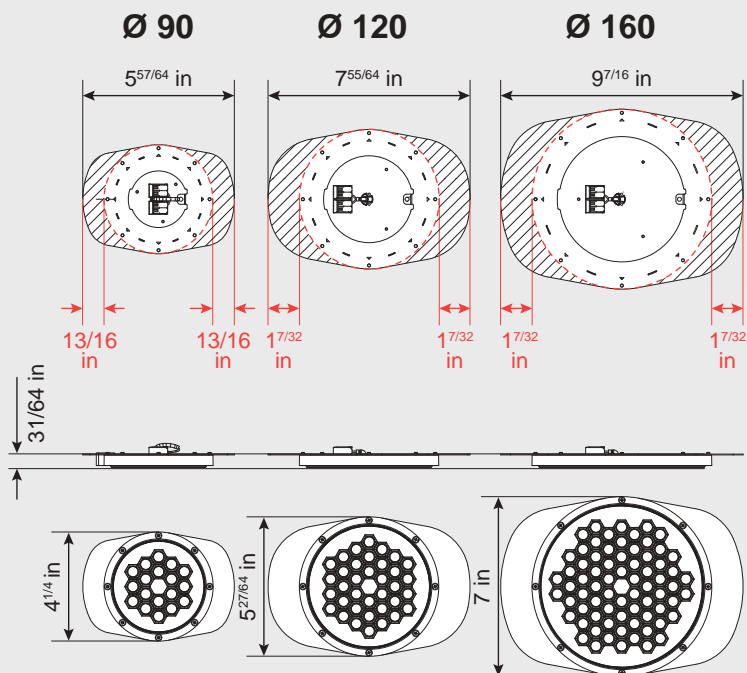

1b

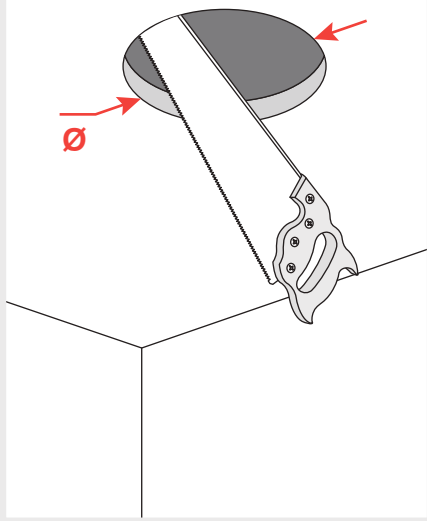

2b

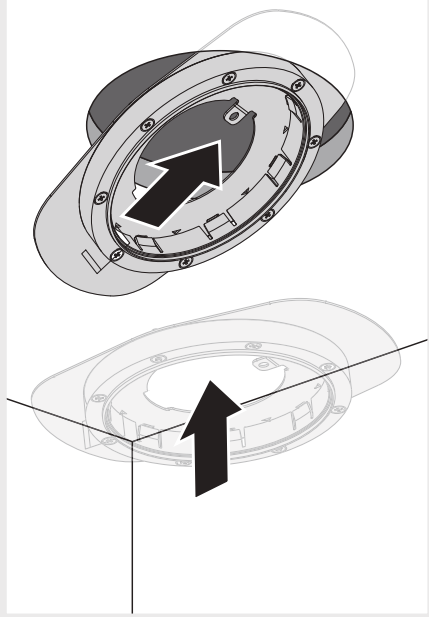

i

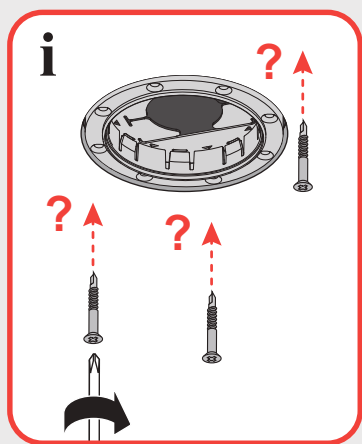

Ø 90-120-160

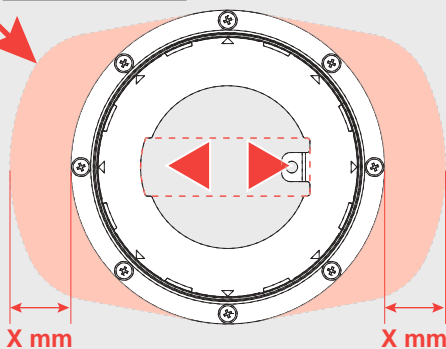

Ø	90	120	160
X [mm]	21	31	31

3b

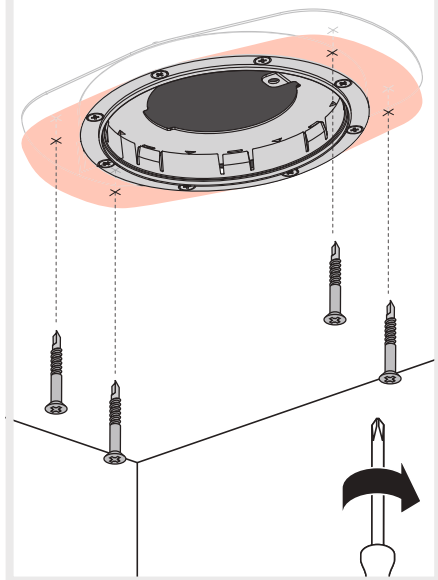

4b

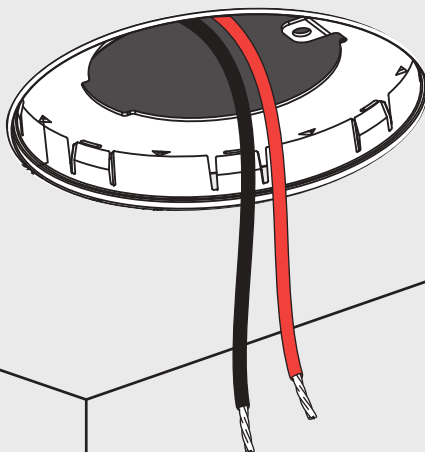
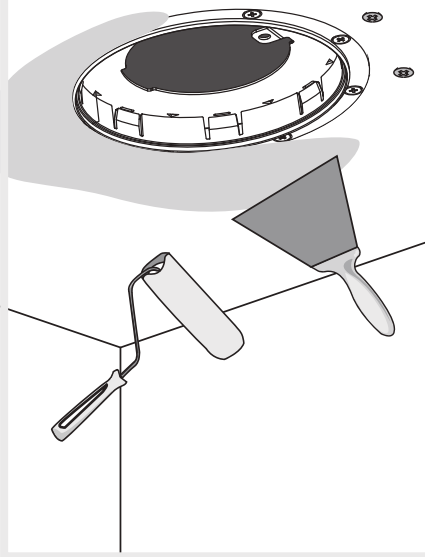

TRIM FRAME & TRIMLESS FRAME

5

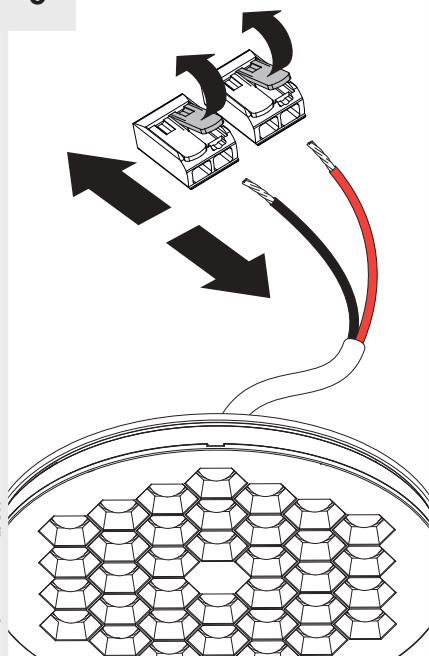

6

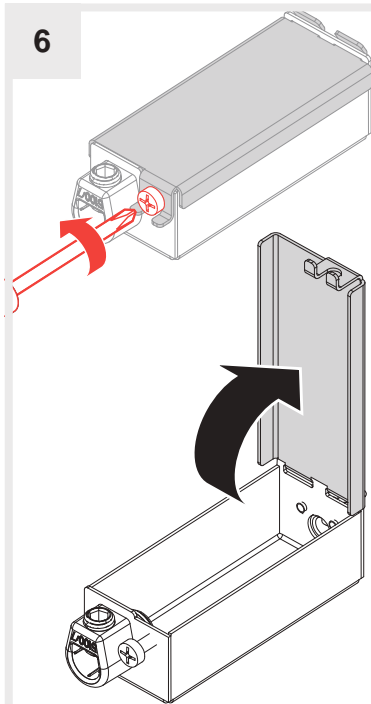

7

Use only CMG cable
Utilisez uniquement CMG câble
Utilice únicamente el cable CMG

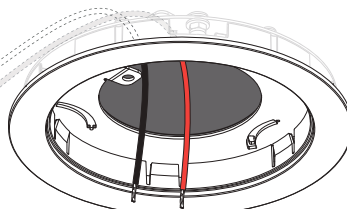
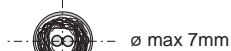

Use only with class 2 power unit
Utiliser exclusivement avec class 2 alimentation
Utilícese únicamente con unidad de alimentación de clase 2

red/rouge/rojo + CLASS 2
black/noir/negro - CLASS 2



⊕ Rosso/Red/Rouge/Rojo/Rot
⊖ Nero/Black/Noir/Negro/Schwarz

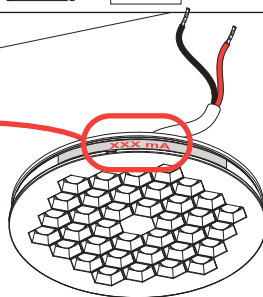
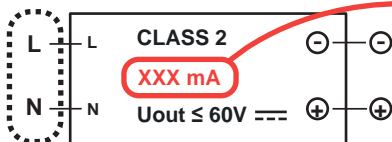

8

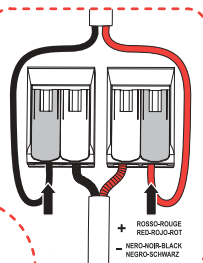
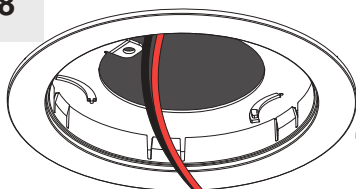

11 mm

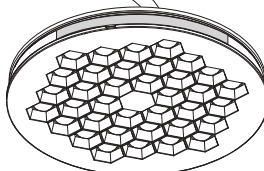
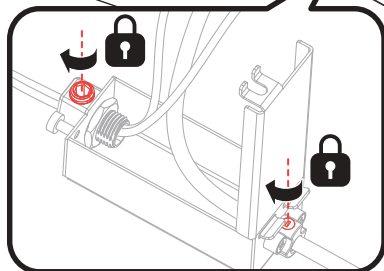

9

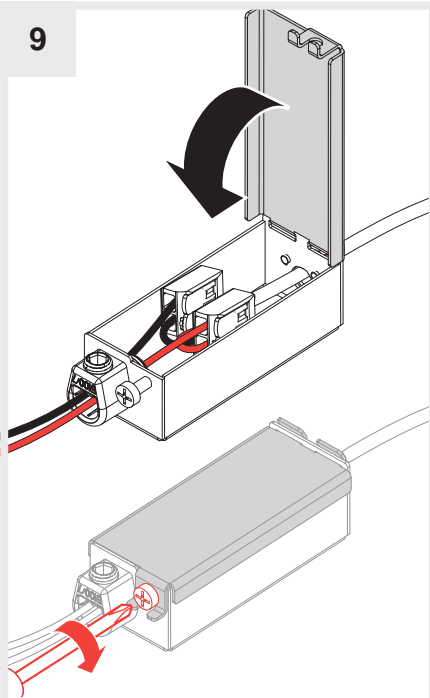

10

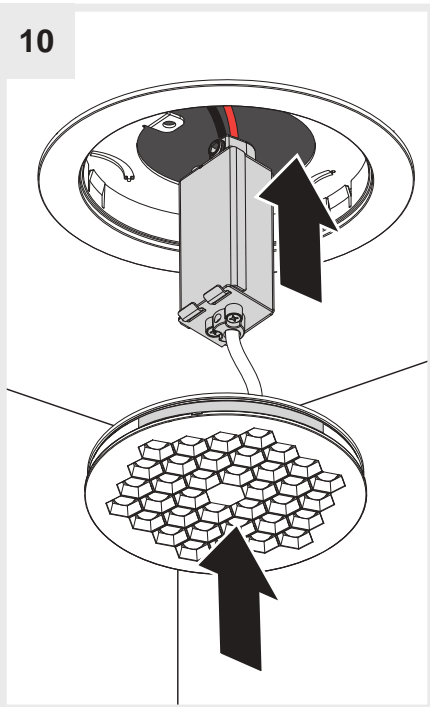

11

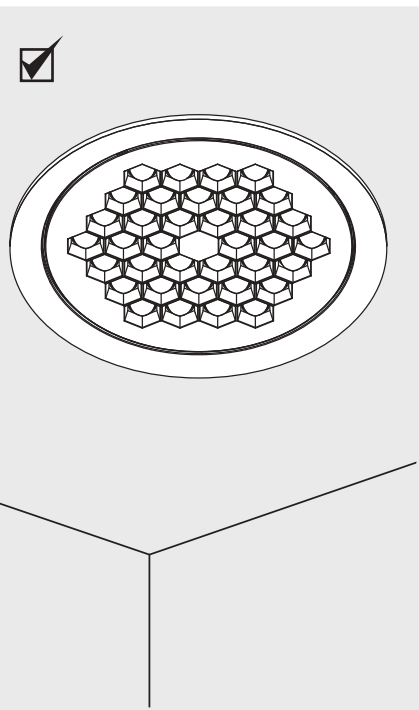
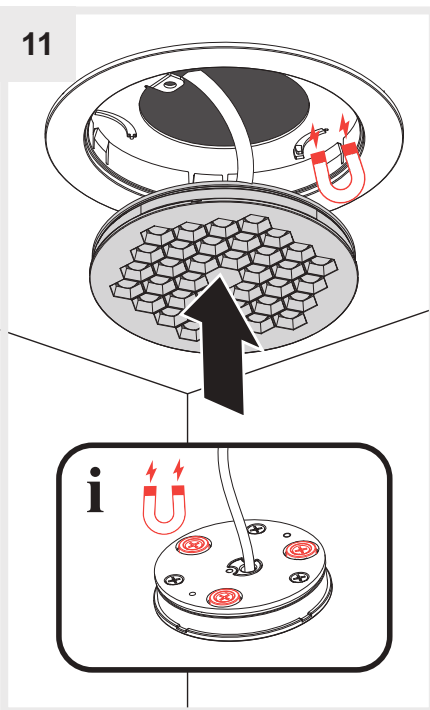

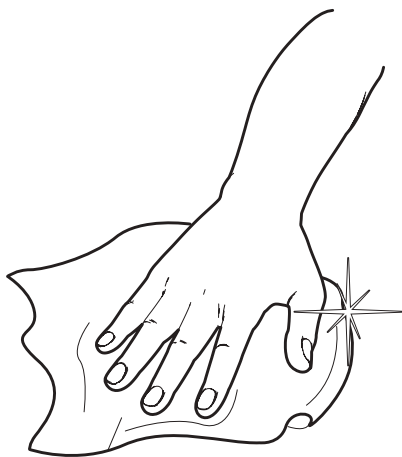
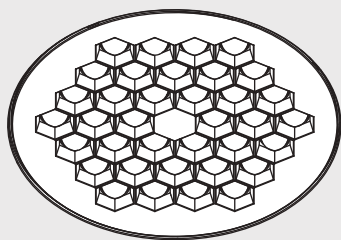



1

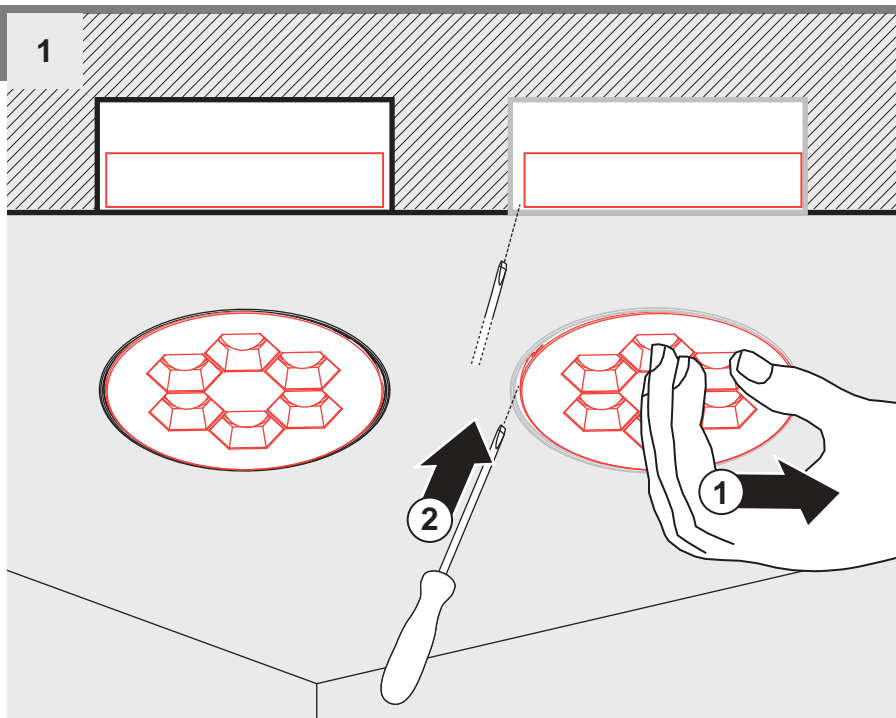

2

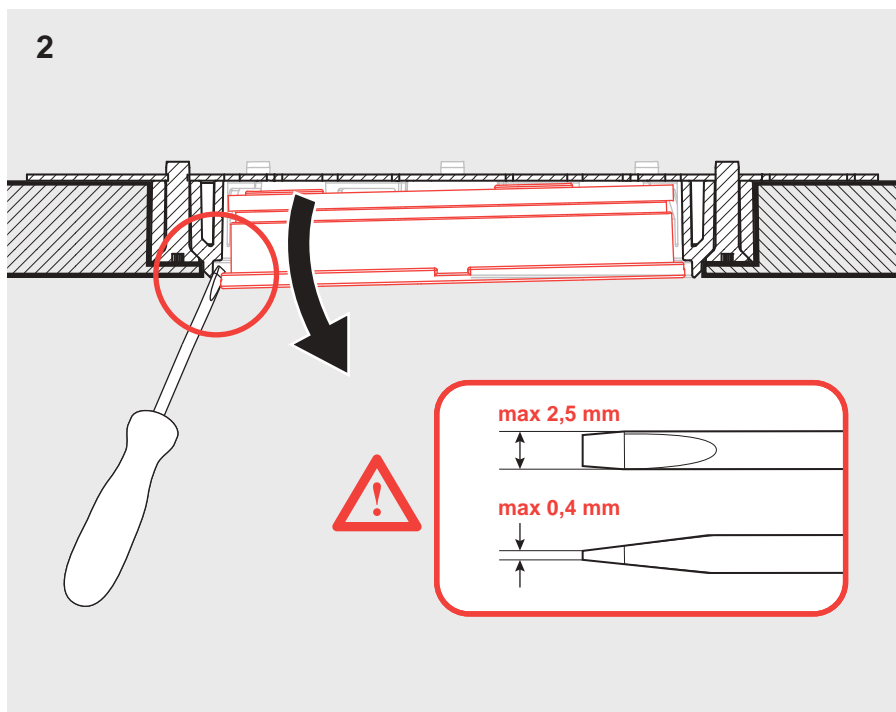

Artemide®



Artemide

via Bergamo, 18
20006 Pregnana M.se (MI)
ITALIA

tel. +39 02 935 181
fax +39 02 935 90 254
fax +39 02 935 90 496

www.artemide.com

VAT IT00846890150

Artemide Inc.

250 Karin Lane
Hicksville, NY 11801

tel. 631 694 9292
Toll Free 1-877-Art-9111
Fax 631 694 9275

www.artemide.net

cod. Y513002019B